

# PLAN OF SUBDIVISION

## EDITION 1

## PS723488J

### LOCATION OF LAND

**PARISH:** MOORABBIN  
**CROWN DESCRIPTION:** DENDY'S CROWN SPECIAL SURVEY (PART)  
**TITLE REFERENCES:** VOL. 4834 FOL. 624  
**LAST PLAN REFERENCE:** LOT 80 ON LP9500  
**POSTAL ADDRESS:** 28 DEGA AVENUE BENTLEIGH EAST 3165  
 (at time of subdivision)

COUNCIL NAME: GLEN EIRA CITY COUNCIL

### VESTING OF ROADS AND/OR RESERVES

IDENTIFIER	COUNCIL/BODY/PERSON
NIL	NIL

### NOTATIONS

**DEPTH LIMITATION:** Does Not Apply

This is an ePlan

**SURVEY:**  
 This plan is based on survey.

### EASEMENT INFORMATION

LEGEND: A-Appurtenant Easement E-Encumbering Easement

Section 12(2) of the Subdivision Act 1988 applies vide this plan

IDENTIFIER	PURPOSE	WIDTH (m)	ORIGIN	LAND BENEFITED/IN FAVOUR OF
E1	DRAINAGE AND SEWERAGE	3.05	LP9500	LOTS ON LP9500



Suite 5, 11 Sabre Drive PORT MELBOURNE VIC 3207  
 PO Box 530 BENTLEIGH VIC 3204  
 PH +61 3 9557 1407

SURVEYORS FILE REF: 2336

LICENSED SURVEYOR: MARY C RABLING

VERSION 1

ORIGINAL SHEET  
 SIZE: A3

SHEET 1 OF 2

This plan is unregistered and may be subject to change.

Plan generated date/time: 13/12/2018 10:42 AM

PS723488J

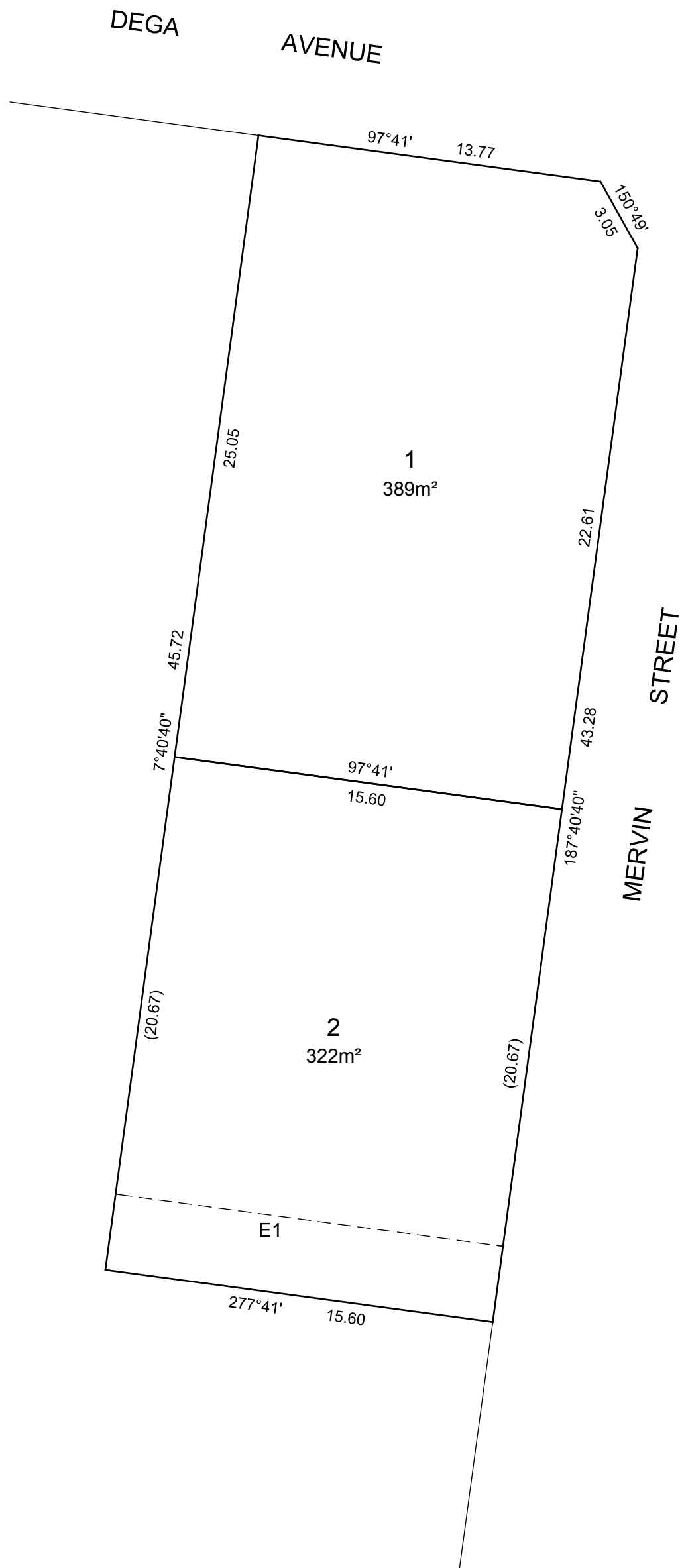

Suite 5, 11 Sabre Drive PORT MELBOURNE VIC 3207  
PO Box 530 BENTLEIGH VIC 3204  
PH +61 3 9557 1407

SCALE  
1 : 200

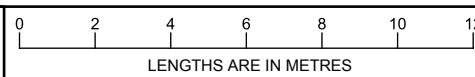

ORIGINAL SHEET  
SIZE: A3

SHEET 2

LICENSED SURVEYOR: MARY C RABLING  
VERSION 1

This plan is unregistered and may be subject to change.

Plan generated date/time: 13/12/2018 10:42 AM